

7. Function check the transition from “Semi” to “Binary,” Scenario II
 - A. Move the Selector to “Semi” Mode.
 - B. Ensure that the Hammer is cocked.
 - C. Pull the trigger and keep it held back.
 - D. The Hammer should fall forward and impact the Firing Pin.
 - E. With the Trigger still held back, re-cock the Hammer on the Disconnecter.
 - F. Hold the Trigger back while turning the Safety Selector to Binary Mode.
 - G. The Selector should not be able to fully turn to Binary Mode.
 - H. Continue to maintain pressure on the Selector.
 - I. Release the Trigger while continuing to maintain pressure on the Selector.
 - J. The Hammer should not move.
 - K. Now release pressure on the Selector.
 - L. The Hammer should fall off of the Disconnecter and be caught by the Sear.

8. Function check Binary Mode, Scenario I
 - A. Ensure that the Hammer is cocked on the sear.
 - B. Move the Safety Selector to “Binary” Mode.
 - C. Pull the Trigger and keep it held back.
 - D. The Hammer should fall forward and impact the Firing Pin.
 - E. Re-cock the Hammer on the Disconnecter.
 - F. Slowly release the Trigger until the Hammer falls to the Firing Pin.
 - G. Keep your finger held at the point that the Hammer fell forward
 - H. Re-cock the Hammer on the Disconnecter.
 - I. Release the trigger and the hammer should reset to the Sear.



9. Function check Binary Mode, Scenario II
 - A. Ensure that the Hammer is cocked on the sear.
 - B. Move the Safety Selector to “Binary” Mode.
 - C. Pull the Trigger and keep it held back.
 - D. The Hammer should fall forward and impact the Firing Pin.
 - E. Re-cock the Hammer on the Disconnecter.
 - F. Slowly release the Trigger until the Hammer falls to the Firing Pin.
 - G. Keep the Trigger held at the point that the Hammer fell forward
 - H. Re-cock the Hammer on the Disconnecter.
 - I. Pull the Trigger in and the Hammer should not fall.
 - J. Release the Trigger slowly until the Hammer falls to the Firing Pin.
 - K. While keeping your finger at the breaking point, re-cock the Hammer.
 - L. Release the Trigger again, and it should reset at the Sear.

10. Function check intermodal travel from Binary Mode to Semi Mode.
 - A. Ensure that the Hammer is cocked on the sear.
 - B. Ensure that the Safety Selector is in “Binary” Mode.
 - C. Pull the Trigger and keep it held back.
 - D. The Hammer should fall forward and impact the Firing Pin.
 - E. Re-cock the Hammer on the Disconnecter.
 - F. Continue to hold the Trigger back
 - G. Rotate the Safety Selector from “Binary” Mode to “Semi” Mode.
 - H. Release the Trigger.
 - I. The Hammer should fall off the Disconnecter and rest on the Sear.

This concludes the function test of the BFS III™.

What to Expect When Live Fire Testing the BFS III™:

- WARNING:** Keep your finger off the trigger until you are ready to shoot.
- WARNING:** Never point your firearm at anything that you do not intend to destroy.
- WARNING:** Be sure of your target and what is behind it.

Test the Safe Mode:

With the Safety Selector in Safe Mode, the Trigger should not move, and the Hammer should not fall forward.

Test Semiautomatic Mode:

With the Safety Selector in Semi Mode, the firearm should fire one round every time the Trigger is pulled.

When the Trigger is released, the Hammer should reset to the Sear.

Test Binary Mode:

With the Safety Selector in Binary Mode, the firearm should fire once every time the Trigger is pulled and once again when the Trigger is released.

By releasing the Trigger slightly more, an audible reset should be perceived.

Note: It may be possible to fire on the pull phase in Binary Mode, and then again on the release phase in Binary Mode, but if the release phase reset is not performed, an operator can potentially pull the trigger again and then firearm will not fire. However, when the Trigger is released a second time, the firearm will fire. It is recommended that the operator use a “pull through, release through” technique when operating in Binary Mode.

Note: Depending on your specific firearm gas system, you may want to use a stiffer buffer spring to help prevent the possibility of hammer follow as a function of carrier speed. If hammer follow should occur, it will be likely that it will only occur under sustained “full speed” conditions. Additional modifications to your firearm gas port and carrier weight will further mitigate the potential of hammer follow with the BFS III™. It is beyond the scope of this document to provide all of the possible options to perfect the cycling of your firearm. If you are unsure of how to make any potential modifications to your firearm, it is recommended that you contact a Franklin Armory® Certified Armorer.

If you have a suggestion on how to improve this testing procedure or if you have any questions, please contact Franklin Armory® directly at info@franklinarmory.com

FRANKLIN ARMORY® PATENTED BINARY FIRING SYSTEM III™ WAIVER AND RELEASE

1. STATEMENT OF OPEN AND OBVIOUS DANGER REGARDING THE BINARY FIRING SYSTEM™:

Firearms, by their very nature, can be lethal. The Franklin Armory® Binary Firing System III™ (BFSIII™) may inadvertently cause INJURY or even DEATH if improperly installed or misused. The BFSIII™ is a unique multi-mode trigger system that requires proper installation and user training for safe operation. Improper use, misuse, or untrained use of the BFSIII™ may lead to the unintentional discharge of the firearm which may cause the following:

**PROPERTY DAMAGE
PERSONAL INJURY TO SELF OR OTHERS, OR
DEATH!**

It is imperative that the BFSIII™ only be installed, adjusted, and/or repaired by a certified Franklin Armory® armorer. Failure to use a Franklin Armory® armorer to install your trigger may expose you to serious liability including **PROPERTY DAMAGE, PERSONAL INJURY TO YOUR SELF OR OTHERS, AND/OR DEATH!** Improper installation, use, or tampering with the BFSIII™ will void the warranty and MAY LEAD TO UNINTENTIONAL DISCHARGE OF THE FIREARM THAT MAY LEAD TO INJURY OR EVEN DEATH. **NEVER ALTER ANY COMPONENT OF THE BFSIII™, AND NEVER OPERATE THE BFSIII™ IF ANY OF THE COMPONENTS ARE MISSING, DAMAGED, OR WORN.** AFTER THE BFSIII™ HAS BEEN PROPERLY INSTALLED, IT IS IMPERATIVE THAT ALL USERS SEEK QUALIFIED TRAINING ON HOW TO USE THESE PRODUCTS. Please see the coupon on the back side of this waiver for an offer for high quality subsidized training with LMS Defense.

WARNING!

THE FRANKLIN ARMORY® BFSIII™ HAS THE ABILITY TO FIRE UPON THE PULL AND THE RELEASE OF THE TRIGGER. Please refer to the BFSIII™ manual for further operational instructions.

WARNING!

FRANKLIN ARMORY® RECOMMENDS THAT ALL USERS ATTEND A TRAINING CLASS OFFERED BY LMS DEFENSE PRIOR TO OPERATING A BFSIII™ EQUIPPED FIREARM. IMPROPER UNDERSTANDING OF HOW THE TRIGGER OPERATES MAY LEAD TO UNINTENTIONAL DISCHARGE OF THE FIREARM AND MAY LEAD TO INJURY OR EVEN DEATH.

WARNING:

NEVER USE THE BFSIII™ WITH ANY ACCESSORY THAT MIGHT CREATE A SAFETY HAZZARD. SOME SLINGS, BUMP FIRE STOCKS, OR OTHER ACCESSORIES MAY NOT BE SAFE FOR USE WITH THIS PRODUCT.

WARNING:

NEVER RELY ON MECHANICAL FEATURES. IT IS YOUR RESPONSIBILITY TO ENSURE SAFE HANDLING OF ANY FIREARM INCLUDING THIS BFS III™ EQUIPPED FIREARM.

WARNING:

IT IS THE BUYER'S RESPONSIBILITY TO ENSURE THAT THEY ARE IN COMPLIANCE WITH ALL APPLICABLE LAWS AT ALL TIMES WHILE USING THIS PRODUCT. SOME STATES WILL NOT ALLOW CIVILIANS TO USE THE BFS III™.

2. COMPREHENSION OF RISK:

The BFSIII™ trigger has the ability to fire on the pull and the release of the trigger. By purchasing and/or using the Franklin Armory® BFSIII™, YOU COMPREHEND THE INHERENT RISK, including without limitation, of LIABILITY, INJURY, LOSS, DAMAGE or DEATH as a result of improper installation, use, misuse, tampering, and/or abuse of the BFSIII™.

3. ASSUMPTION OF RISK:

By purchasing and/or using the Franklin Armory® BFSIII™, YOU ASSUME ALL INHERENT RISK AND PERSONAL RESPONSIBILITY, including without limitation, of LIABILITY, INJURY, LOSS, DAMAGE or DEATH as a result of improper installation, use, misuse, and/or abuse of the BFSIII™.

4. WAIVER OF RIGHTS:

By purchasing and/or using the Franklin Armory® BFSIII™, you waive and release any claim for damages, indemnity, or reimbursement against Franklin Armory® for any claims, fines, or damages imposed upon you for use of the BFSIII™. In addition, you agree to release Franklin Armory® (including its independent contractors, affiliated entities, parent companies, subsidiaries, present and former employees, owners, officers, members, managers, partners, contractors, insurers, shareholders, and directors) from any and all claims, actions, damages, liabilities, losses, costs and expenses (including, without limitation, attorney fees) for death, injury, loss, or damage of property in any way arising out of the purchase and use of the Franklin Armory® BFSIII™. By purchasing and/or using the Franklin Armory® BFSIII™, you agree to limit liability to actual damages arising from gross negligence or willful misconduct of Franklin Armory®. In no event shall Franklin Armory® be liable for any special, incidental, punitive, or consequential damages or other indirect damages.

5. INDEMNIFICATION:

By purchasing or using the Franklin Armory® BFSIII™, you agree to accept responsibility for your use of the product and any consequence or fine imposed upon you by any government entity or third party and to indemnify and hold harmless Franklin Armory® for any claims made resulting from your use of the BFSIII™.

6. TRANSFER OF PRODUCT:

If you should sell, lease, let someone borrow or use, or in any way transfer the BFSIII™ to any other individual, you agree, as a condition of acquiring this product, to accept the responsibility of insuring that the transferee is fully aware and agrees to the conditions set forth herein. Failure to disclose these conditions to a third party without first providing acknowledgement and acceptance by the transferee of the conditions set herein will be grounds for liability on the part of the transferor.

7. BINDING EFFECT:

By purchasing the Franklin Armory® BFSIII™, you agree that this waiver shall be binding upon you as well as your next of kin, personal representatives, heirs, beneficiaries, and assigns and shall inure to the benefit of Franklin Armory® and successors and assigns of Franklin Armory®.

8. SEVERABILITY:

If any provision of this Waiver and Release is for any reason declared to be invalid or unenforceable, the validity and enforceability of the remaining provisions will not be affected. The invalid or unenforceable provision will be deemed modified to the extent necessary to render it valid and enforceable, and if no modification may render it valid and enforceable, this Waiver and Release will be construed as if not containing such provision and the rights and obligations of the parties will be construed and enforced accordingly.

9. GOVERNING LAW:

This Waiver and Release shall be governed in all respects by the laws of the state of Nevada without regard to conflict and law principles. Any action or claim shall be brought in Douglas County, Nevada.

10. DISPUTE RESOLUTION: ARBITRATION

To the extent permitted by applicable law, any controversy or claim arising out of or relating to the product, its design, functionality, or materials, and this contract, or breach thereof, will be settled by binding arbitration in accordance with the Commercial Arbitration Rules of the American Arbitration Association. Under this arbitration provision, you give up the right to resolve any controversy or claim arising out of or relating to the product, including its design, functionality, materials, or this contract by a judge and/or a jury. You also agree not to participate as a class representative or class member in any class action litigation, any class arbitration or any consolidation of individual arbitrations. The parties specifically agree to the binding nature of the arbitration.

11. VOLUNTARY ACTION:

While we sincerely value every Franklin Armory® customer, there is no necessity for anyone to own a Franklin Armory® BFSIII™. There are many other high quality firearms and triggers that the consumer may purchase instead of our products. Please take your time in deciding whether to purchase the BFSIII™ products. We intend to maintain supply, so please do not rush this important decision. Please contact the Franklin Armory® factory if you have any questions. However, if for any reason the conditions set forth in this agreement are unacceptable to you, THEN DO NOT PURCHASE THIS PRODUCT.

If you have already purchased a Franklin Armory® BFSIII™, and you do not agree to the terms set herein, then we encourage you to IMMEDIATELY RETURN THE PRODUCT TO YOUR RETAILER in an unused, new, condition. Refund terms will be set by each independent retailer.

THIS IS A WAIVER AND RELEASE OF LIABILITY. YOU AGREE TO THIS ENTIRE DOCUMENT. YOU AGREE TO ALL OF THE PROVISIONS HEREIN AND UNDERSTAND THAT YOU HAVE GIVEN UP SUBSTANTIAL RIGHTS BY AGREEING TO ALL OF THE PROVISIONS. BY PURCHASING, AND CONTINUING TO RETAIN THESE PRODUCTS, YOU ARE INDICATING YOUR VOLUNTARY AGREEMENT TO THE PROVISIONS OF THIS WAIVER AND RELEASE OF LIABILITY.

Thank you for purchasing your new firearm equipped with the Binary Firing System III™

We want to do everything we can to help you be safe with your new firearm. Franklin Armory® has partnered with LMS Defense to provide high quality training specifically addressing operational skills with the BFSIII™. Both LMS Defense and Franklin Armory® believe in *safety first*. As such, LMS Defense is offering incentivized BFSIII™ training to all buyers of the BFSIII™. Take as much as \$100 off on a two day class! To sweeten the deal, Franklin Armory® will further incentivize BFSIII™ buyers to take the training by offering a 25% discount code to all BFSIII™ owners that pass an LMS Defense class covering BFSIII™ curricula.

To register, go to www.lmsdefense.com/schedule and use “Franklin BFS” as the discount code to get \$50 off a one day class or \$100 off a two day class.



Offer void where prohibited by law. Offer subject to change.

FRANKLIN ARMORY® BFSIII™ OPERATION MANUAL

Patent #9,952,012 , 9,952,013, 10,107,580, and 10,393,461.

WARNING!

READ AND COMPREHEND THIS DOCUMENT ENTIRELY BEFORE USING THE BFSIII™

WARNING!

THE FRANKLIN ARMORY® BFS III™ HAS THE ABILITY TO FIRE UPON THE PULL AND THE RELEASE OF THE TRIGGER. READ AND UNDERSTAND THE OPERATION OF THIS FIREARM BEFORE USING IT!

WARNING!

THIS PRODUCT IS SOLELY DESIGNED FOR USE BY PROFESSIONAL LAW ENFORCEMENT AND HIGHLY TRAINED PERSONNEL.

WARNING!

FRANKLIN ARMORY® RECOMMENDS THAT ALL USERS ATTEND A TRAINING CLASS OFFERED BY LMS DEFENSE PRIOR TO OPERATING A BFS III™ EQUIPPED FIREARM. IMPROPER UNDERSTANDING OF HOW THE TRIGGERS OPERATE MAY LEAD TO UNINTENTIONAL DISCHARGE OF THE FIREARM AND MAY LEAD TO INJURY OR EVEN DEATH.

BFS III™ COMPONENT IDENTIFICATION AND NOMENCLATURE:

1. Disconnecter
2. White Disconnecter Spring
3. IDS
4. IDS Spring
5. Trigger
6. C-Clip
7. IDS Guide Rod (and C-Clip)
8. Spacer (x2)
9. Slave Pin
10. Selector, Long Paddle, Short Paddle, and Screws
11. NA
12. Hammer Spring (Clear and Blue)
13. Trigger Spring (Clear and Red)
14. Hammer & Trigger Pins
15. Buffer Spring
16. Hammer
17. Red Label

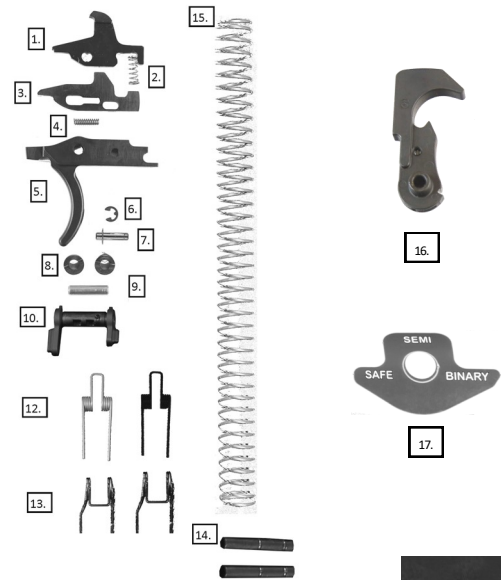

BFS III™ Three Position Safety Selector:

“SAFE” MODE:

As viewed from the left side of the firearm, “Safe” Mode is indicated by the Safety Selector pointing to the 9 o’clock position. In order for Safety Selector to be placed into this position, the Hammer must be cocked. While in Safe Mode, the Trigger will be prevented from moving due to contact with the Safety Selector.

“SEMI” MODE:

When the Safety Selector is pointing straight up at 12 o’clock, the firearm is in Semiautomatic Mode. For ease of reading, “Semi” is used to equate to Semiautomatic Mode. In this position, the firearm will fire one round with every pull of the Trigger. It is not designed to fire upon release of the Trigger while in this mode.

“BINARY” MODE:

As viewed from the left side of the firearm, “Binary” Mode is indicated by the Safety Selector pointing to the 3 o’clock position. In this position, the firearm will fire one round with every *pull* of the Trigger, and one round with every *release* of the Trigger.

It is important to note that the BFS III™ is engineered to have a positive and audible reset upon release of the Trigger while in Binary Mode. Please note that if the operator should pull the Trigger back prior to reset, the Hammer will not be released when the Trigger is pulled. However, when the Trigger is subsequently released, the Hammer will be allowed to fall to the Firing Pin. Consequently, it is recommended that BFS III™ operators use a “pull through, release through” technique.

The BFS III™ Safety Selector is designed to lockout the option of rotating from Semi Mode to Binary Mode while the Trigger is held back. Do not attempt to force the Safety Selector further during this instance.

WARNING: Always point the muzzle in a safe direction whether pulling, holding back, or releasing the Trigger.

WARNING: Always point the muzzle in a safe direction when modulating the Safety Selector.



If the operator, after pulling the Trigger while in Binary Mode, should decide to negate the option of firing a round with the release function of the Trigger, he or she may keep the Trigger held back while using the offhand to modulate the Safety Selector back to Semi Mode. After fully modulating the Safety Selector back to Semi Mode, the operator can then release the Trigger and allow it to reset on the sear.



WARNING:

This task does require fine motor skills. Consequently, always point the muzzle in a safe direction while performing this task!

BFS III™ Dry Fire Function Check List

Before using your BFS III™ equipped firearm for the first time, and each time you use your firearm again thereafter, we recommend that each operator run through the following litany of dry fire function checks. By doing so, you will not only ensure that your BFS III™ is operating correctly, you will also train your thought process on what to expect from your trigger system.

WARNING: Always insure that your firearm is completely unloaded before performing a dry fire test. Remove the ammunition magazine, and insure that there is not a loaded round in the chamber. Best yet, perform this task with the upper receiver and magazine removed.

WARNING: Even though you believe your firearm is unloaded, it is always important to point your muzzle in a safe direction while performing the following tasks.



1. Function Check the Disconnecter Motion.

- A. With the Selector on Binary and the Hammer forward, push on the tail of the Disconnecter.
- B. The IDS protrusion should slip under the front tip of the Disconnecter.



2. Function Check the IDS Motion.

- A. With the Selector in Binary and the Hammer forward, push on the back of the IDS.
- B. The IDS protrusion should slip out from under the front tip of the Disconnecter.



3. Function check the Safety.

- A. Ensure that the Hammer is cocked on the sear.
- B. Move the Safety Selector to “Safe” Mode.
- C. Pull the Trigger.
- D. The Trigger should not move.
- E. Move the Safety Selector back to “Semi” Mode.
- F. The Hammer should not fall forward.

4. Function check the transition from “Semi” to “Safe.”

- A. Ensure that the Hammer is cocked on the sear.
- B. Move the Safety Selector to “Semi” Mode.
- C. Pull the Trigger and keep it held back.
- D. The Hammer should fall forward and impact the Firing Pin.
- E. With the Trigger still held back, re-cock the Hammer on the Disconnecter.
- F. While turning the selector back to “Safe” Mode, the Hammer should not move.
- G. Release the Trigger.
- H. The Hammer should fall to the sear.



5. Function check Semi Mode.

- A. Ensure that the Hammer is cocked on the sear.
- B. Pull the Trigger and keep it held back.
- C. The Hammer should fall forward and impact the Firing Pin.
- D. With the Trigger still held back, re-cock the Hammer.
- E. It should now be held back by the Disconnecter.
- F. Release the Trigger
- G. The Hammer should now fall to the sear and not to the Firing Pin.

6. Function check the transition from “Semi” to “Binary,” Scenario I

- A. Move the Selector to “Semi” Mode.
- B. Ensure that the Hammer is cocked.
- C. Pull the trigger and keep it held back.
- D. The Hammer should fall forward and impact the Firing Pin.
- E. With the Trigger still held back, re-cock the Hammer on the Disconnecter.
- F. Hold the Trigger back while turning the Safety Selector to Binary Mode.
- G. The Selector should not be able to turn to Binary Mode.
- H. The Hammer should not have fallen while manipulating the selector.
- I. Now release the Trigger.
- J. The Hammer should fall off of the Semiautomatic Disconnecter and be caught by the sear.